



ANGEL REAL ESTATE  
GROUP

“SELL THE WORLD TO THE WORLD  
SERVICE THE WORLD TO THE WORLD”





# CONTENTS

|    |                    |
|----|--------------------|
| 3  | About us           |
| 4  | Key Competence     |
| 5  | Core Business      |
| 7  | Service Provided   |
| 9  | Our Global Reach   |
| 12 | Current Project    |
| 22 | Industrial Land    |
| 26 | Project Management |

# ABOUT US



Starting operations in 2014, Angel Real Estate was formed by a skillful team with backgrounds in different sectors related to the properties market in Thailand and Turkiye. The company used all the different insights to create bespoke investment solutions to the clients.

Throughout the years it has consolidated its position as one of the most reliable entities for those who care to make their investments internationally.

The year 2023 marks a new era for Angel Real Estate to expand and diversify more services to international market such as Angel Club, Used Properties, Property Leasing, Hospitality Services, Industrial Land Factories, Land and Thailand Privilege Card



## KEY COMPETENCE

- Worldwide Network & Partnership
- In depth knowledge and professional in international market
- Strong and extensive network of business partnership
- Full range of One Stop Services
- Sold more than 12,500 condominium units since 2014 with 20,000 customer's base

ANGEL REAL ESTATE



# CORE BUSINESS

ANGEL REAL ESTATE

- New Project Sales & Marketing
- Asset Management Properties Sales & Marketing
- Property Management
- Project Consultancy
- Property for sales and rent
- After Sale Services
- Thailand Privilege Card
- Industrial Land & Factories, Cities & Agriculture Land

## REGIONAL OFFICES

- Thailand (Regional Offices)  
(Bangkok, Chiangmai, Phuket)
- Hong Kong Office
- Malaysia (Lauban Office)
- China  
(Beijing, Chengdu, Shanghai)
- Liaison Office - Japan/ Turkiye  
Myanmar/Brunei

Recovering from Covid Pandemic, in 2023 Angel Real Estate facing all up and down in the past 10 years, has strongly established and provided better selection of

- 1) Good location, Quality Condominium, Housing Projects and Building in Bangkok, Chiangmai, Phuket and Istanbul (Turkiye)
- 2) Asset management good quality used housing and condominium
- 3) Industrial Land and Factories
- 4) Land in cities areas
- 5) Agriculture Land
- 6) Hotels
- 7) Project management services thru our subsidiary company CBMT
- 8) Thailand Privilege Card and other Visa services
- 9) Rental: short and long term, Furniture package, Maid services, Transfer ownership services and Transportation services

- Own brand management strategy
- Diversified business model
- Global customer service foundation
- International real estate marketing experience
- Multiple targets audiences and marketing strategies
- Wide and solid business partnership



# OUR GLOBAL REACH

ANGEL REAL ESTATE

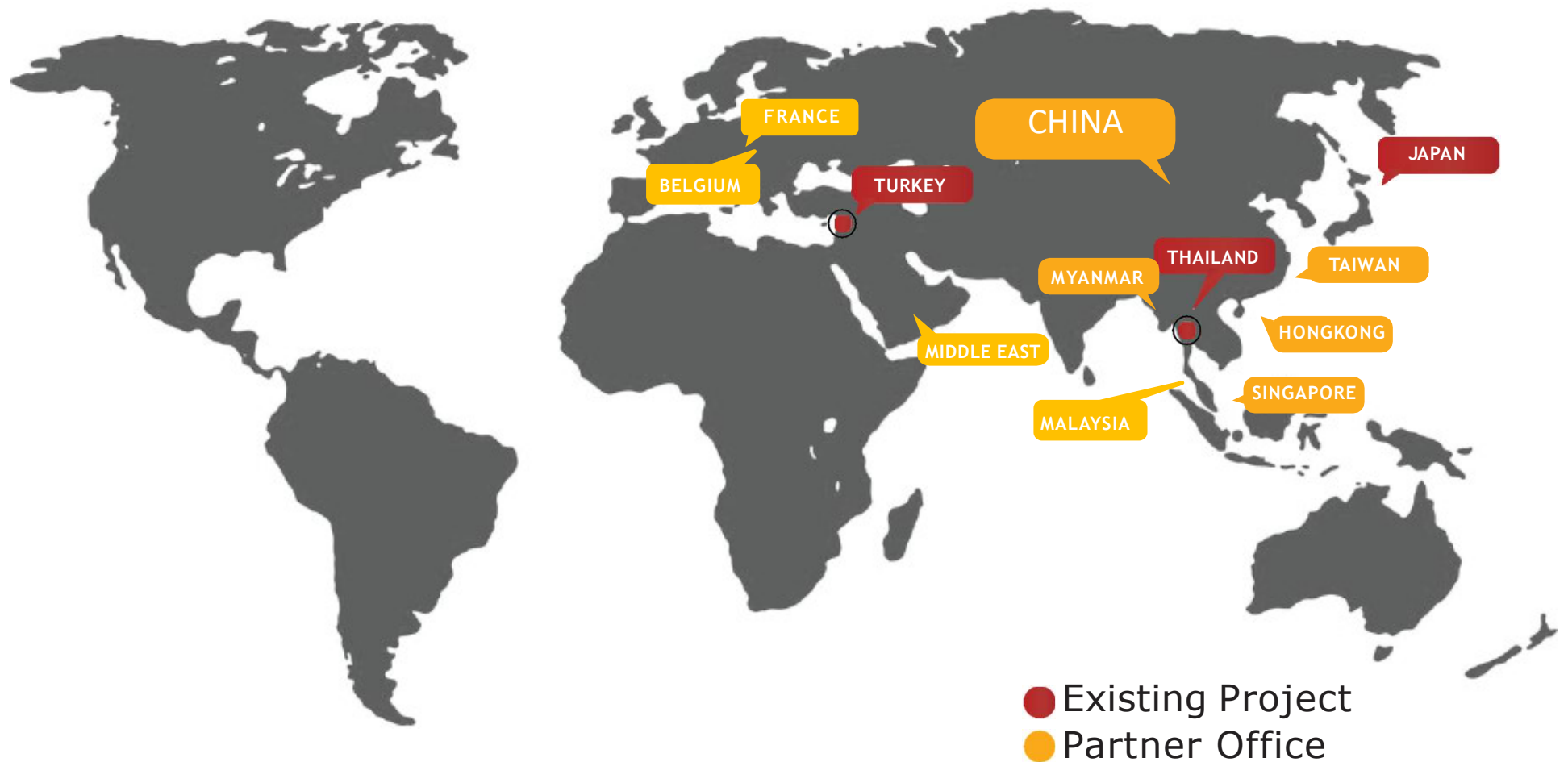

● Existing Project  
● Partner Office





# THAILAND PROJECTS

## CONDOMINIUM & HOUSING

ANGEL REAL ESTATE

SANSIRI



ORNSIRIN

CI CHARN  
ISSARA

ANANDA

FYNN

RISLAND



SCASSET

SIAMESE  
RAMA 9



THE ROOM  
SUKHUMVIT 38



SUPALAI  
ICON-SATHORN



SUPALAI  
OREINTAL  
SUKHUMVIT39



FYNN  
SUKUMVIT 10



ARISE  
CHAROEN MUEANG



HABITAT  
SUPER HIGHT WAY



CHEWATHAI  
THONGLOR



CULTURE  
THONGLOR



# THAILAND PROJECTS

## BANGKOK CONDOMINIUM & HOUSING

ANGEL REAL ESTATE



### Sansiri

The Base Phattanakan



### Land & House

The Room Sukhumvit 38  
The Bangkok Thonglor  
The Room Phayathai  
The Key Srinakarin

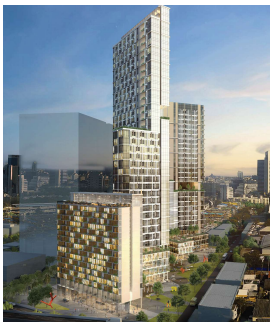

### Siamese Asset

Siamese Rama 9

### Supalai

Supalai Icon Sathorn  
Supalai Oriental Sukhumvit 39  
Supalai Prime Rama 9  
Supalai Veranda Sukhumvit 117  
Supalai City Resort Sukhumvit 107  
Supalai Parc



### Chan Issara

Baan Bangna  
The Issara Sathorn



### Others

Life Rama 4-Asoke  
Scope Thonglor & Langsuan  
Artale Rama 9  
Culture Chula  
Chewathai Thonglor  
COBE Ratchada  
Skyrise Avenue Sukhumvit 64  
Serio Sukhumvit 50  
8 Residence  
Fynn Asoke



*And many more..*



# THAILAND PROJECTS

## HOUSING PROJECT

ANGEL REAL ESTATE



**The Gentry Sukhumvit  
Bangna**



**Bangkok Boulevard Bangna  
KM5**



**AIRI SUKHUMVIT-BANGNA  
KM 5**



**BAAN ISSARA BANGNA**



**Grand Bangkok Boulevard  
State Bangna**



**Grand Bangkok Boulevard  
Yard Bangna**



**Grand Bangkok Boulevard  
Rama9 Krungthep Kritha**



**Grand Bangkok Boulevard  
Krungthep Kritha**



**95E1**



**ARTALE ASOKE - RAMA 9**

# THAILAND PROJECTS

## CHAINGMAI

ANGEL REAL ESTATE

ARISE CHAROEN-MUANG



ARISE MAHIDOL



ASTRA  
SKY-RIVER



ORNSIRIN HABITAT  
ORNSIRIN BELIVE  
ORNSIRIN VILLE



ASTRA 3  
coming soon



THE NEXT JEDYOD  
PH 1 & 2



ARISE HILL  
coming soon



# THAILAND PROJECTS

## PHUKET

ANGEL REAL ESTATE



ARISE VIBE PHUKET



THE CITY KATHU



SOLD  
**40** UNITS

AVAILABLE  
**3** UNITS



# JAPAN PROJECT

FREE HOLD LANDED HOUSE  
FREE HOLD CONDOMINIUM

ANGEL REAL ESTATE

## BENTENCHO

2-3-4 Ichioka, Minato, Osaka City



## HASHIMOTO

2-3-12 nakamoto higashinari, Osaka City



## SENBONKITA

2 -17-4 Hayashiji, Ikuno-ku, Osaka City







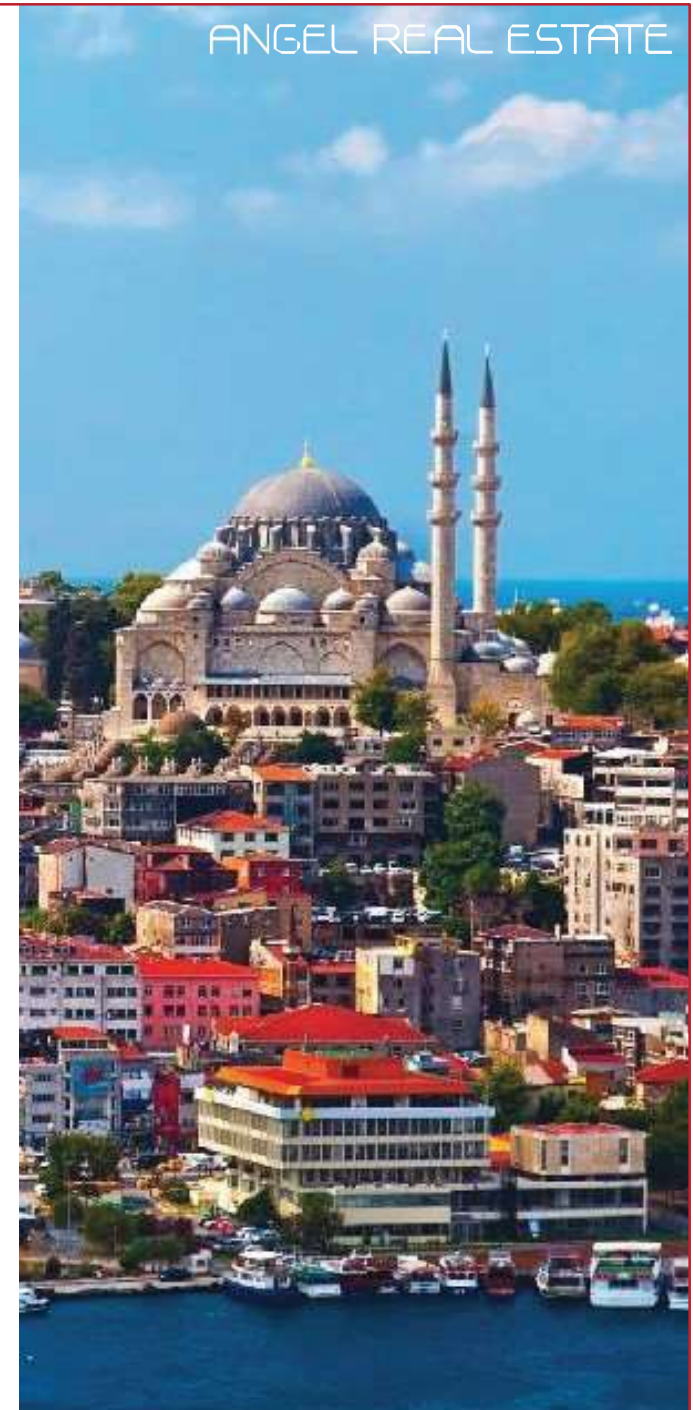
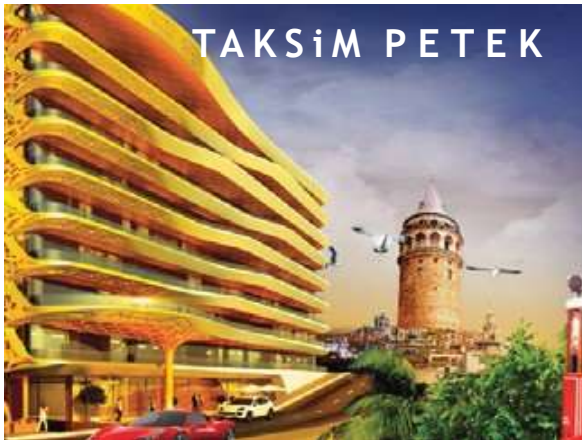



# HOTEL

ANGEL REAL ESTATE

**Thailand** is the world's top tourism destination. Many hotels and resorts have welcomed a lot of visitors from every part of the world. Along with the growing of country's tourism, Thailand's hotel industry have been developing rapidly in the last decades. International hotel chains and local developers are scaling business up in Bangkok, Chiang Mai, Pattaya and Phuket.

Having a strong business connection with many local and foreign investors, Angel Real Estate can facilitate our partners as an investment matchmaker to introduce 3 to 5 stars profitable hotels. Our experienced talent will support clients' requirements with a professional expertise.



# HOTEL

ANGEL REAL ESTATE







**INDUSTRIAL** Land & Factories



# INDUSTRIAL LAND

ANGEL REAL ESTATE

**Angel Real Estate** provides a full-service for industrial and Factories acquisition, mini-factory warehouse and logistic, Also we do provide after-sell service such as setting-up company and accommodation and etc

As the industrial development trend has shift rapidly, Thailand's government had announced the "Eastern Eco- nomic Corridor (EEC)" campaign under scheme of Thailand 4.0 aiming to revitalize and to enhance the well-known Eastern Seaboard Development Program supporting Thailand as a powerhouse for industrial pro- duction for over 30 years. The project situated in EEC area shall be supported and subsidized in total pipeline of production with assorted benefits of logistic, transportation.



INDUSTRIAL ESTATE



MINI FACTORY



LOGISTICS

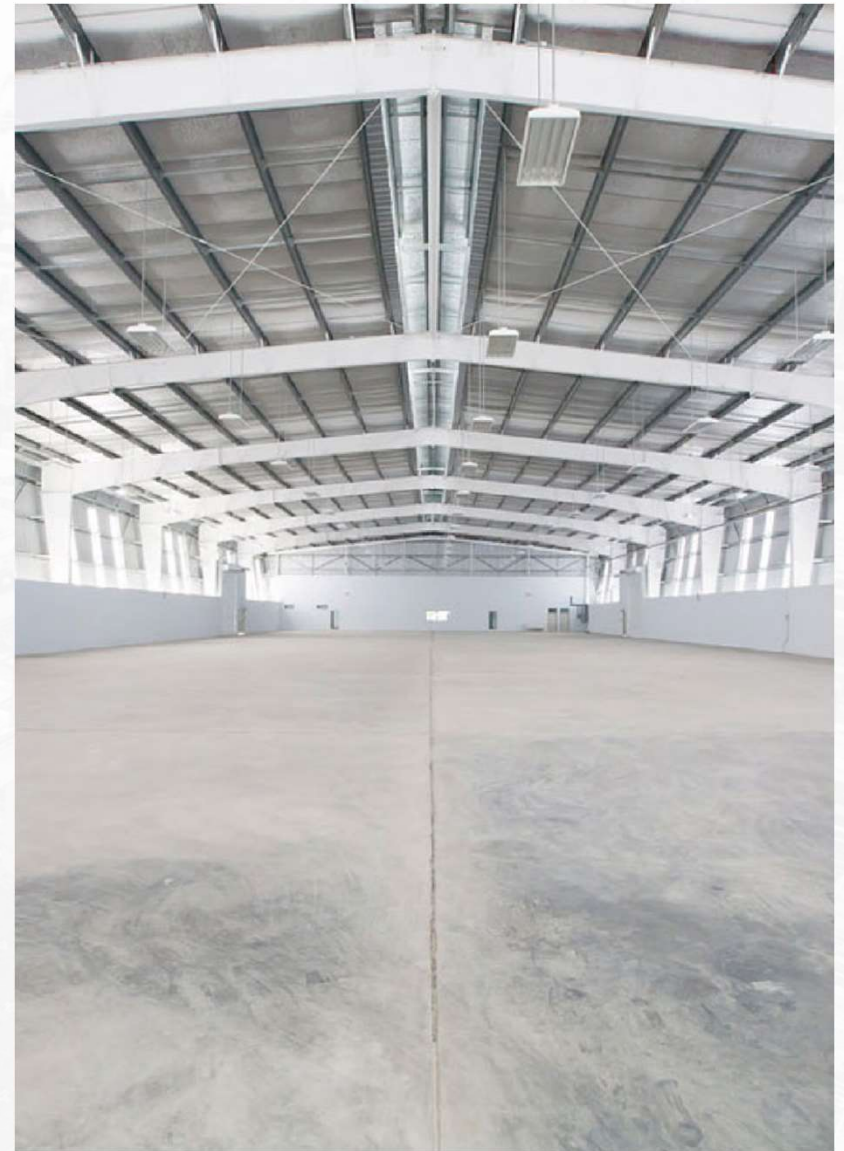

WAREHOUSE



The industry will have a chance to enjoy the BOI incentive providing tax incentive and non-tax incentive.



### 1. Tax Incentives

- Exemption of corporate income tax for up to 13 years
- 50% reduction in corporate income tax for 5 years
- Exemption of import duties on machinery.
- Exemption of import duties on raw or essential materials used in production for export.
- Exemption of import duties on raw or essential materials used in research and development purposes.



### 2. Non-Tax Incentives

- 100% foreign ownership.
- Permit to own land.
- Permit to bring in skilled workers and experts to work into the Kingdom.



# AGRICULTURE LAND

ANGEL REAL ESTATE





An aerial, high-angle photograph of a modern interior space, likely a lounge or bar. The floor is made of dark, wide-plank wood. Several round tables are scattered throughout, some with people sitting at them. In the center, there's a long, low white table with a black top section. To the right, there's a long, dark leather sofa. In the bottom left, there's a long wooden table with two large, round, metallic objects, possibly speakers or lamps. The lighting is warm and ambient, with some pendant lights visible. The overall atmosphere is contemporary and sophisticated.

ANGEL REAL ESTATE

# PROJECT MANAGEMENT

HOSPITALITY MANAGEMENT FACILITY  
MANAGEMENT  
CBMT

# FACILITY MANAGEMENT







ANGEL REAL ESTATE

# AFTER SALES SERVICE

ANGEL CLUB

# WHAT IS **ANGEL CLUB** ?

Angel Club is setup as our business unit dedicated to serving the clientele who invested in Angel Real Estate recommended properties or Consultancy projects in Thailand. We also provide the excellent concierge services for the needs of our clients.





# SERVICE PROVIDED

ANGEL REAL ESTATE

## IN-HOUSE SERVICES

- Furniture Packages
- Smart Home Packages
- Rental Service Packages
- Plumbing - Maintenance
- Electrical - Maintenance
- Maid Services

## SUPPLEMENTARY SERVICES

- Thailand Privilege Cards
- International Schools – Recommendation
- Legal Services - Recommendation
- Thai Immigration Visa
- Turkiye Migration Service
- Car Rental & Transportation
- Translation Service
- Hospitals – Health Check up



# THAILAND PRIVILEGE CARD

Thailand Privilege



**"Angel Real Estate  
Is An Authorized Agent  
On Behalf Of  
Thailand Privilege Card  
In Order To Offer Membership  
As Code SA23/005"**





# THAILAND PRIVILEGE CARD



The Gold Card offers you a life of value during your stay in Thailand, providing a diverse range of living choices.

**5 Years**  
VALIDITY

**900,000 THB**  
MEMBERSHIP FEE



The Platinum Card grants you the opportunity to relish any desired living experience in Thailand, offering an expanded array of choices and an extended stay duration.

**10 Years**  
VALIDITY

**1,000,000 THB**  
MEMBERSHIP FEE



The Diamond Card, experience a redefined luxury living in Thailand, offering a maximum 15-year stay with exclusive access and privileges tailored to your desired living experience.

**15 Years**  
VALIDITY

**2,500,000 THB**  
MEMBERSHIP FEE



## VISA

- Long-term VISA from 5 up to 20 years++

## AIRPORT VIP SERVICES

- VIP Greeting and Assistance
- Fast track immigration
- Airport transfer
- Airport lounge access

## LIFESTYLE PRIVILEGES

### STAY

- Complimentary membership from leading hotel chains
- Free complimentary night
- Special privileges from hotels and real estate partners nationwide

### TRAVEL

- Free domestic ticket
- Special deals from airlines, river cruise, limousine and car rental

### LEISURE

- Lifestyle privileges and discounts from lifestyle partners
- Exclusive offers, lounge access, personal shopper at leading shopping centers
- World class entertainment and concert tickets
- VIP movie tickets at leading cinemas
- Co-working space

### HEALTH & WELL-BEING

- Complimentary spa, health and wellness packages
- Complimentary health check-up
- Access to fitness clubs

### WEALTH

- Wealth and Investment advisor
- Networking and Seminar

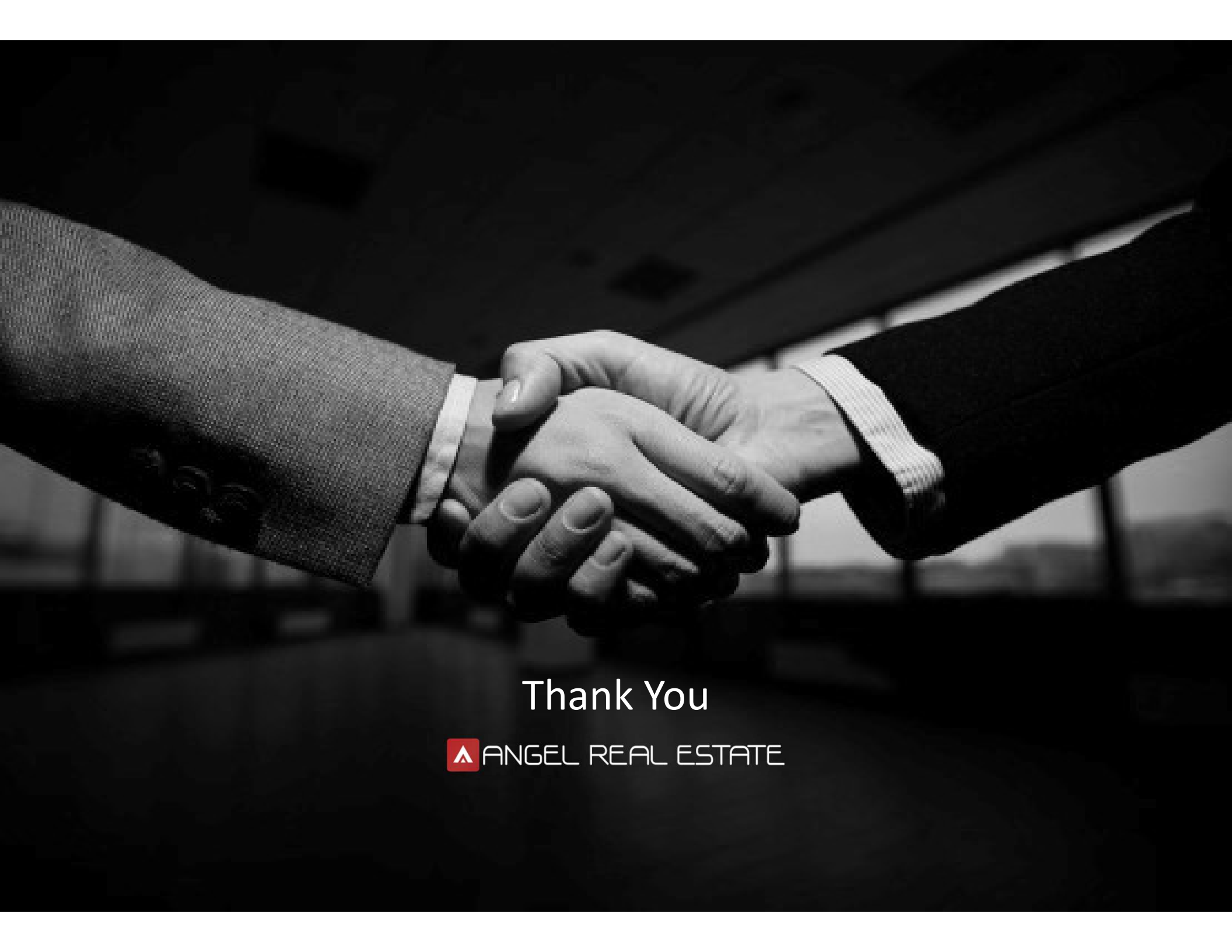

Thank You

